

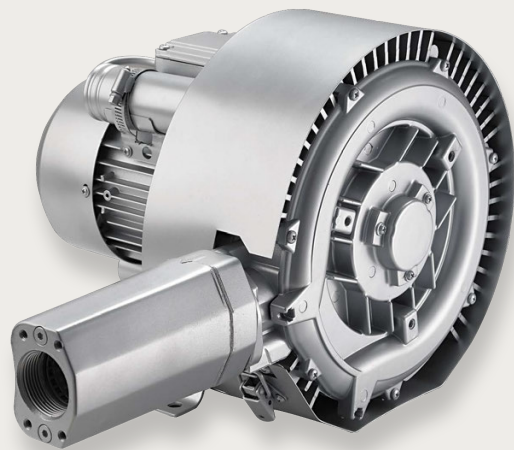

Side channel blower 420 series

The standard VACOM® design, with housing an impeller made of aluminum alloy, is a direct drive configuration, with a dynamically balanced impeller, fitted directly on the motor shaft. The impeller rotates inside of the stator housing with a very small clearance. The absence of lubricants guarantees a 100% oil free vacuum or compression. Construction features of the VACOM® side channel blower are the very reliable operation and low maintenance. VACOM® blowers are directly driven, impellers fixed directly on the drive shaft. Impeller bearing is installed in the front cover and easily to assemble and disassemble. Machines are small and lightweight. VACOM® blowers are already available with differential pressures up to 700 mbar and capacities of 2000 m³/ hr.



Features

- ♦ Available from stock
- ♦ Almost free of maintenance
- ♦ Low power consumption
- ♦ Oil free compression, no oil in the medium
- ♦ Made of aluminum, so low weight and high corrosion resistance.

Accessories

- ♦ Suction filter TGF (for vacuum)
- ♦ Suction filter VCFT (for compression)
- ♦ Pressure relief valve DB
- ♦ External silencer EGD
- ♦ Fittings
- ♦ Various: change valve, pressure gauge, non return valve



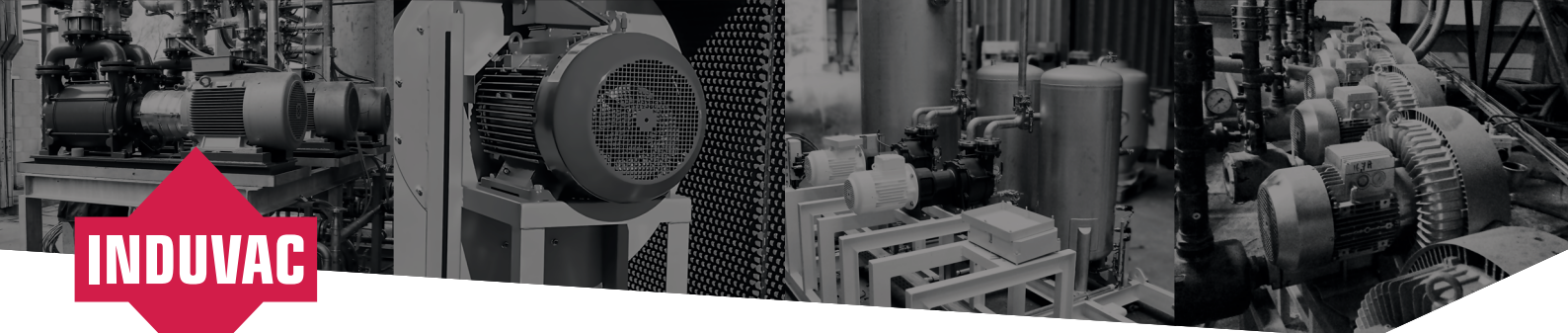

Technical data

Type No.	Curve No.	Freq. Hz	Power kW	Voltage V		Current A		Capacity m ³ /hr	Pressure difference mbar		Sound level dB(A)	Connec-tion °G	Weight kg				
				Δ	Y	Δ	Y		Vacuum	Pressure							
VC 315-420	42A	50	1,75	220-240	Δ	380-420	Y	6,00	Δ	3,45	Y	150	-320	310	64	2	32
	42B	60	2,00	265-290	Δ	460-520	Y	5,90	Δ	3,40	Y	180	-300	280	70	2	32
		50	1,50	IE3	230	Δ	400	Y	5,20	Δ	3,00	Y					
	60	1,75	IE3	Δ	480	Y					2,90	Y					
VC 115-420	42C	50	1,50	230				9,00				150	-280	290	66	2	26
	42D	60	1,75	230				10,00				180	-250	280	69	2	26
VC 322-420	42E	50	2,55	220-240	Δ	380-420	Y	8,60	Δ	5,00	Y	150	-320	420	64	2	35
	42F	60	3,00	265-290	Δ	460-520	Y	8,50	Δ	4,90	Y	180	-400	470	70	2	35
		50	2,20	IE3	230	Δ	400	Y	7,53	Δ	4,35	Y					
	60	2,55	IE3	Δ	460	Y					4,17	Y					

Curves

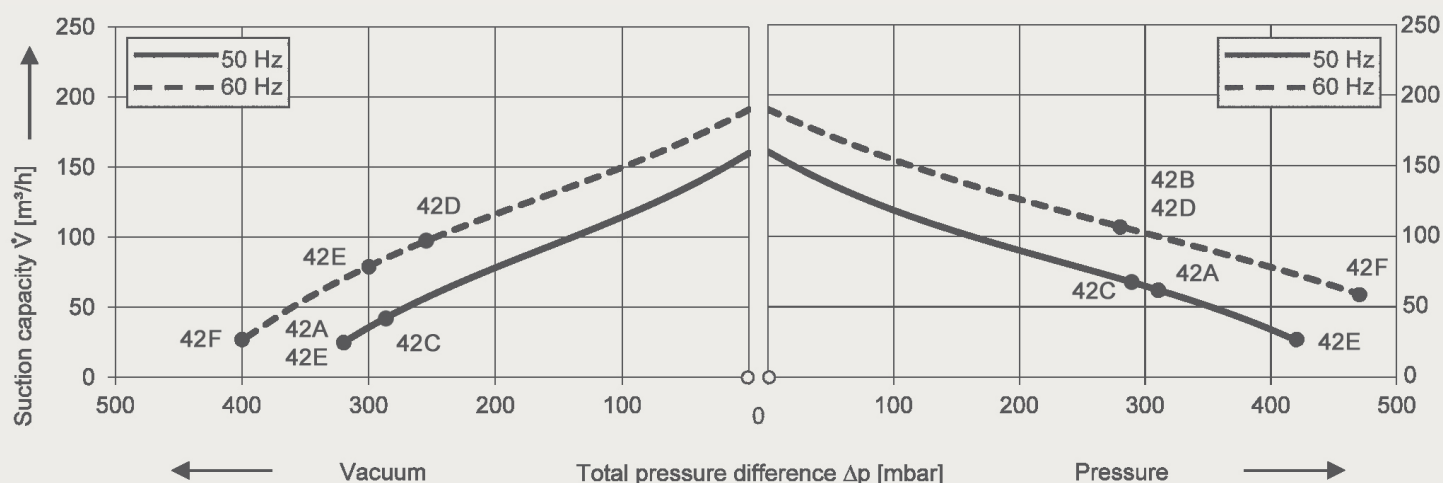

Curves are valid for dry air, with a temperature of 15°C at the inlet and a pressure of 1013 m bar(a) at the inlet or outlet connection (for over- or under-pressure application respectively). The tolerance on capacity is +/- 10%. No rights can be derived from the sketches, dimensions and contents of this data sheet. The data is for information purposes only. Induvac reserves the right to change or modify the data. No complaints can be made about this.

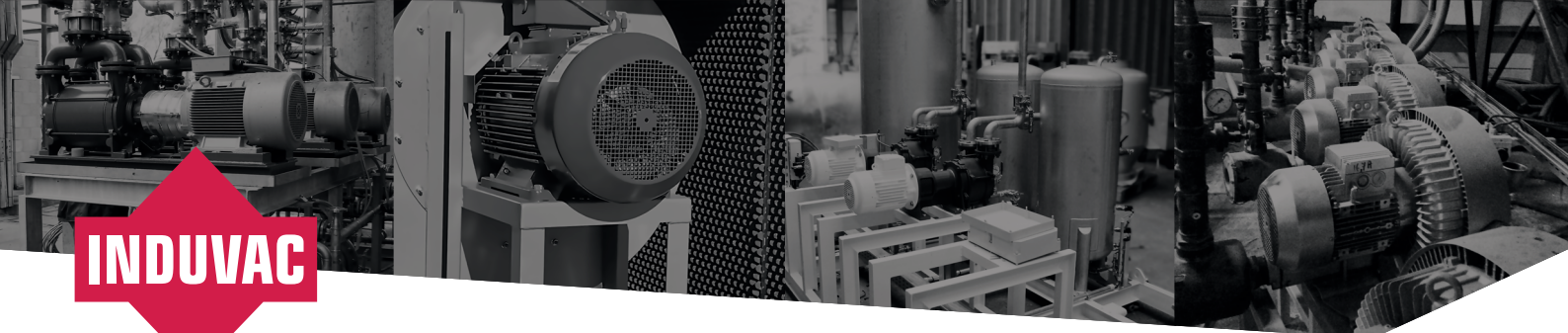

Dimensions

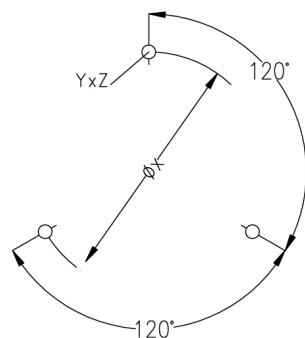
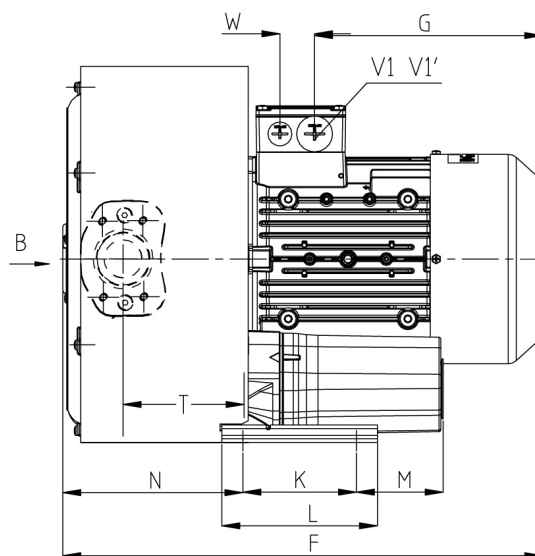
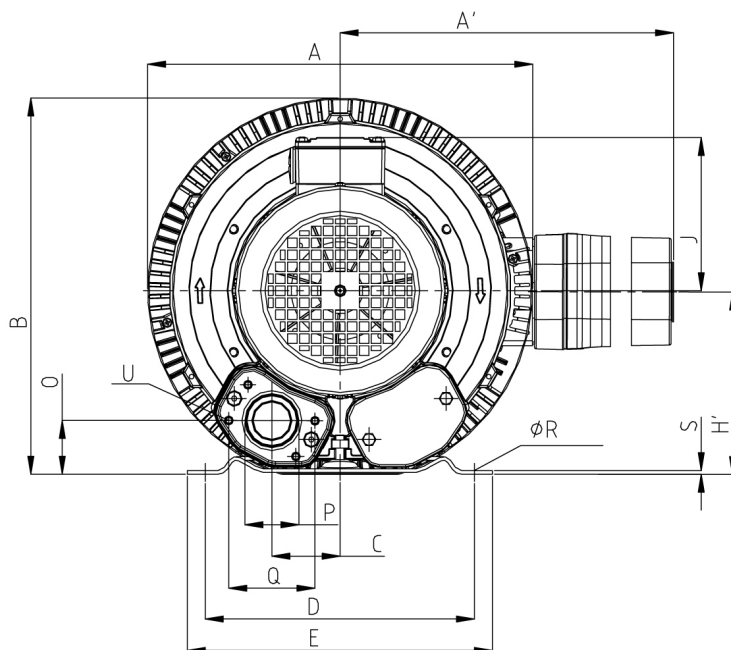

Curve No.	Type	A	A'	B	C	D	E	F	G	H	H'	J	K	L	M
42A / 42B	VC 315-420	322	324	315	58	225	255	401	191	154	153	128	95	130	73
42C / 42D	VC 322-420	322	324	315	58	225	255	401	191	154	153	128	95	130	73
42E / 42F	VC 115-420	322	324	315	58	225	255	401	191	154	153	128	95	130	73
Curve No.	Type	N	O	P	Q	ØR	S	T	U	V1	V1'	ØX	YxZ	X-holes	
42A / 42B	VC 315-420	151	45	G 1 1/2"	72	12	3	104	M6 X 19	M25 X 1.5	M16 X 1.5	174	M6 X 15	0°/120°/240°	
42C / 42D	VC 322-420	151	45	G 1 1/2"	72	12	3	104	M6 X 19	M25 X 1.5	M16 X 1.5	174	M6 X 15	0°/120°/240°	
42E / 42F	VC 115-420	151	45	G 1 1/2"	72	12	3	104	M6 X 19	M25 X 1.5	M16 X 1.5	174	M6 X 15	0°/120°/240°	